

Quick start guide

Lathe Machine

Proxxon Lathe Machine

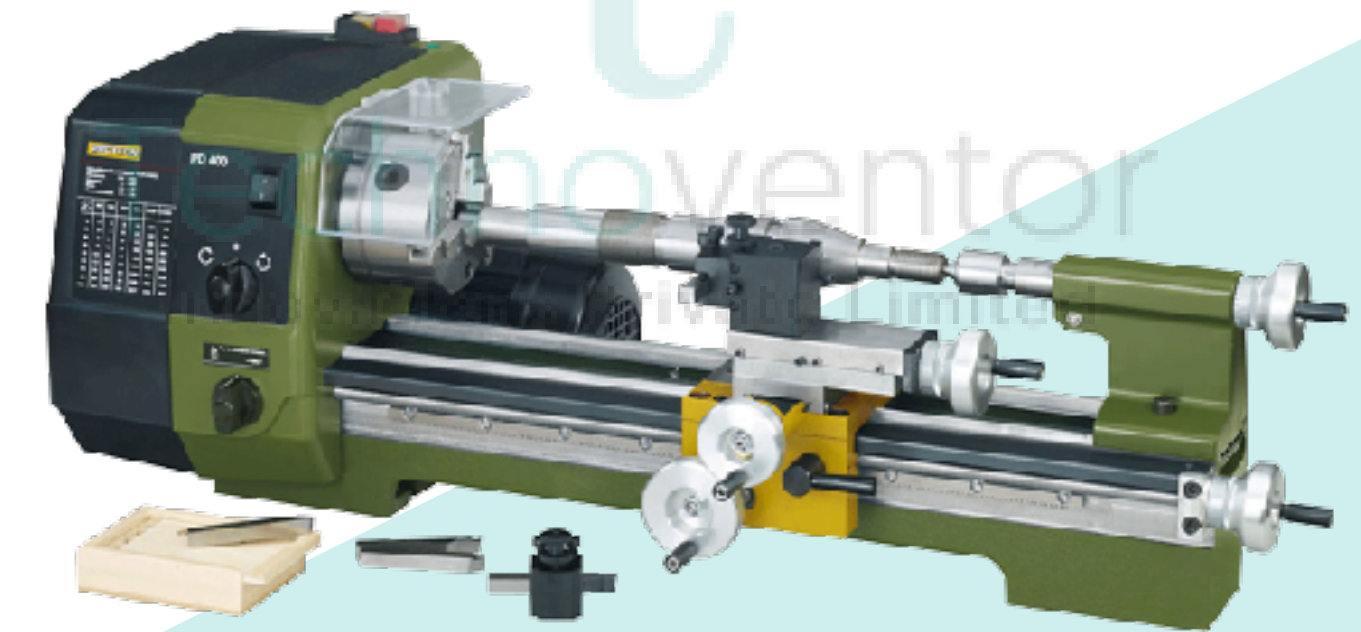

PROXXON



Technoventor
Innovations Private Limited



www.technoventor.com

Machine Startup & Testing

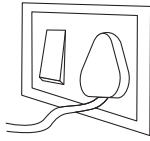
1



Switch OFF the Main switch.

2

Mount central chuck on spindle using 3 bolts provided.



3



Insert internal or external jaws as per requirement.

4

Set spindle speed by changing the belt inside gear box.

80/160 min⁻¹



330/660 min⁻¹



1400/2800 min⁻¹



5

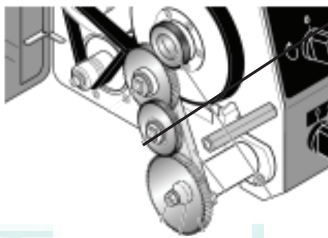

Select gears as per pitch table for automatic feed.

Spindle Speeds [1/min]

Motor 1400/min	Motor 2800/min
80	160
330	660
1400	2800

	W	Z1	Z2	L
10	36	-70	40/25	34/-
11	36	-75	30/20	35/-
12	36	-75	40/34	30/-
14	36	-70	40/34	35/-
16	36	-65	30/50	-34
18	36	-65	40/34	45/-
20	36	-60	40/34	50/-
22	36	-60	40/34	55/-
24	36	-55	40/34	60/-
28	36	-55	40/34	70/-
32	36	-65	30/34	60/-
36	36	-70	20/34	45/-
40	36	-70	20/34	50/-
48	36	-65	20/34	60/-

	mm	Z1	Z2	L
0.2	30	-45	20/60	75/-
0.25	30	-45	25/60	75/-
0.3	30	-55	20/50	60/-
0.35	30	-45	35/60	75/-
0.4	30	-55	20/45	50/-
0.45	30	-60	20/40	50/-
0.5	30	-65	20/30	60/-
0.6	30	-65	20/30	50/-
0.7	30	-55	35/45	50/-
0.75	30	-55	30/40	45/-
0.8	30	-55	40/45	50/-
0.9	30	-70	20/25	40/-
1.0	30	-50	40/30	60/-
1.25	30	-55	50/30	60/-
1.50	30	-55	40/20	60/-
1.75	30	-70	35/20	45/-
2.0	30	-55	50/25	45/-
2.5	30	-55	50/20	45/-
3.0	30	-65	40/20	30/-

	0.07	0.14
W	-30	-30
Z1	20/60	40/60
Z2	70/25	70/25
L	-75	-75

6



Clamp cylindrical workpiece between jaws using key.

7



Support longer workpiece by tailstock.

8

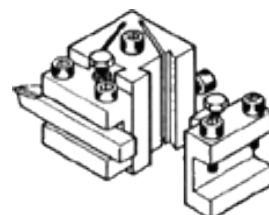

Insert cutting tool in tool post.

Machine Appearance & Accessories

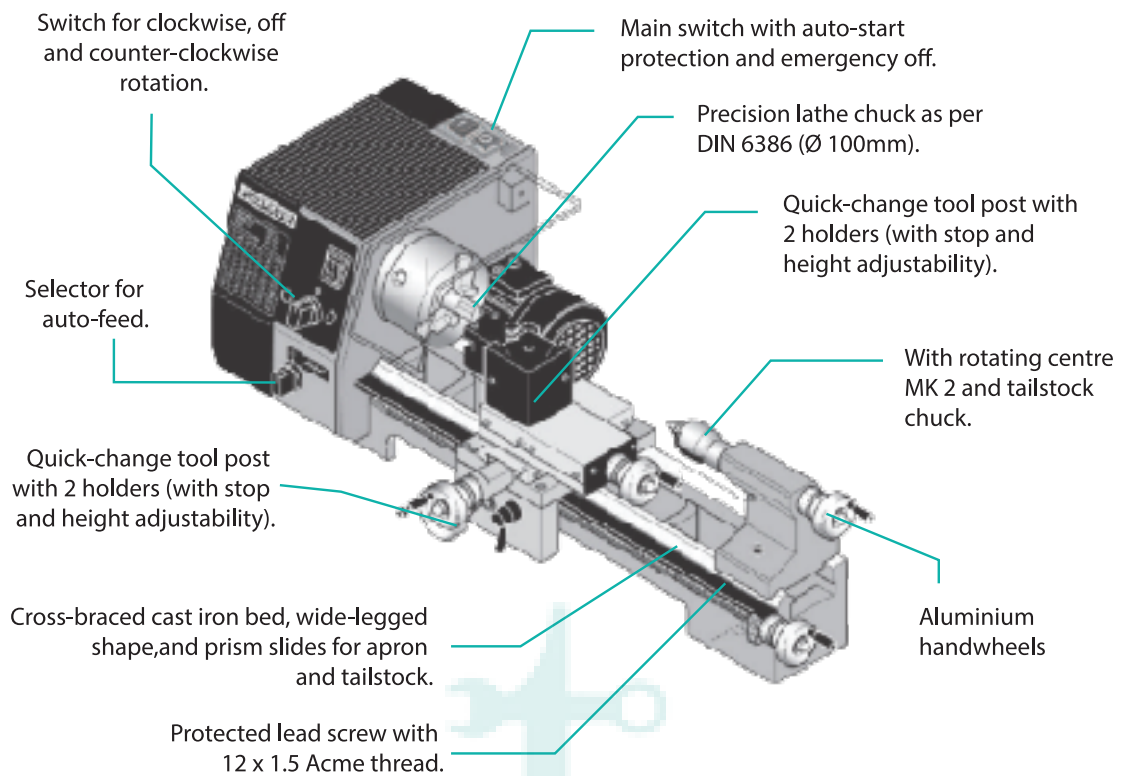

Operation

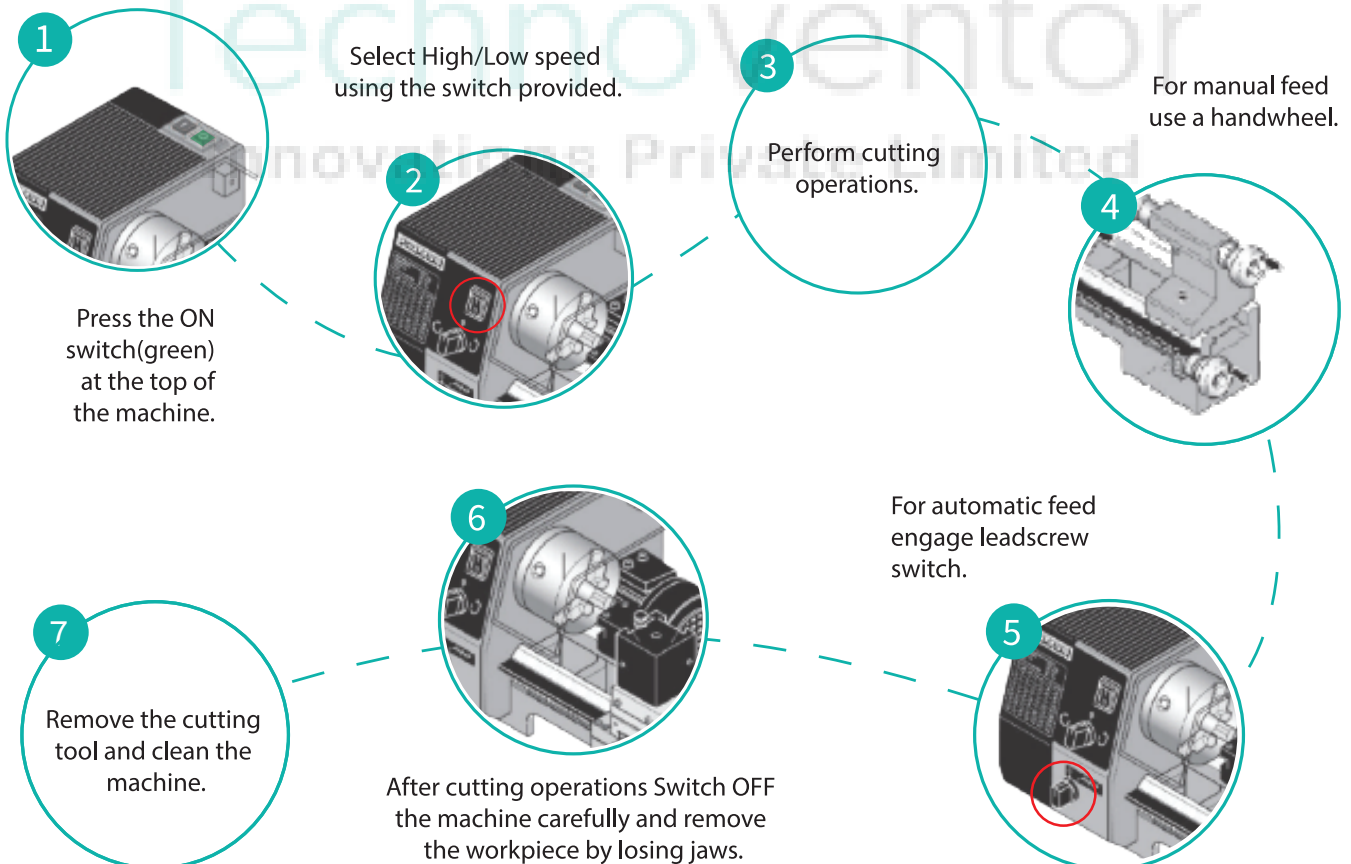

Safety Instructions :

- ✓ Wear safety glasses
- ✓ Make sure the work area is clear from chips, coolant and air-hoses or anything that can get in the way and cause you slip or fall
- ✓ Make sure the cutting, milling tools and work holding equipment are tight before running the spindle
- ✓ All maintenance and repair work should be done with power off
- ✓ Check grease under the bearing cover after every fortnight
- ✓ Always clean and oil the machine after use, do not leave any chips on the guide way
- ✓ Keep the tools and gauges away, to prevent from any damages
- ✓ Safe the slide-ways and unpainted surfaces from rust

Machine Specifications

Centre height	85mm
Centre distance	400mm.
Max. workpiece diameter	116mm
Spindle speeds	80-2800 rpm
Lathe chuck	Inner jaws 3-33mm , Outer jaws 32-83mm
Automatic feed	0.07-0.14 mm/rev
Tool Holder	10*10mm
Dimensions:	900*400*300mm
Weight	45kg.
Voltage	220-240V, 50HZ
Power consumption	550W

For any queries contact:

✉ service@technoventor.com

☎ 8828294964 / 7304419928